



LOBBY RETROFIT PHASE 1
PLAN OPTION REVIEW

lobby plan OPTION 1

Features

- Creation of Screening Area separated from Lobby space with glass partitions/doors
- Doors to be unlocked electronically by receptionist for security purposes
- No seating available in Screening Area (located in Lobby only)
- Glass safety screen above desk to be integrated into new partitions, with opening at transaction area for guest interaction
- Mural to be suspended above desk height or remain on floor
- Revise main Reception desk, removing portion with second computer terminal. Corner desk unit to be enlarged to allow better visual access to receptionist.
- New double doors added at corridor entry leading to Council Chambers

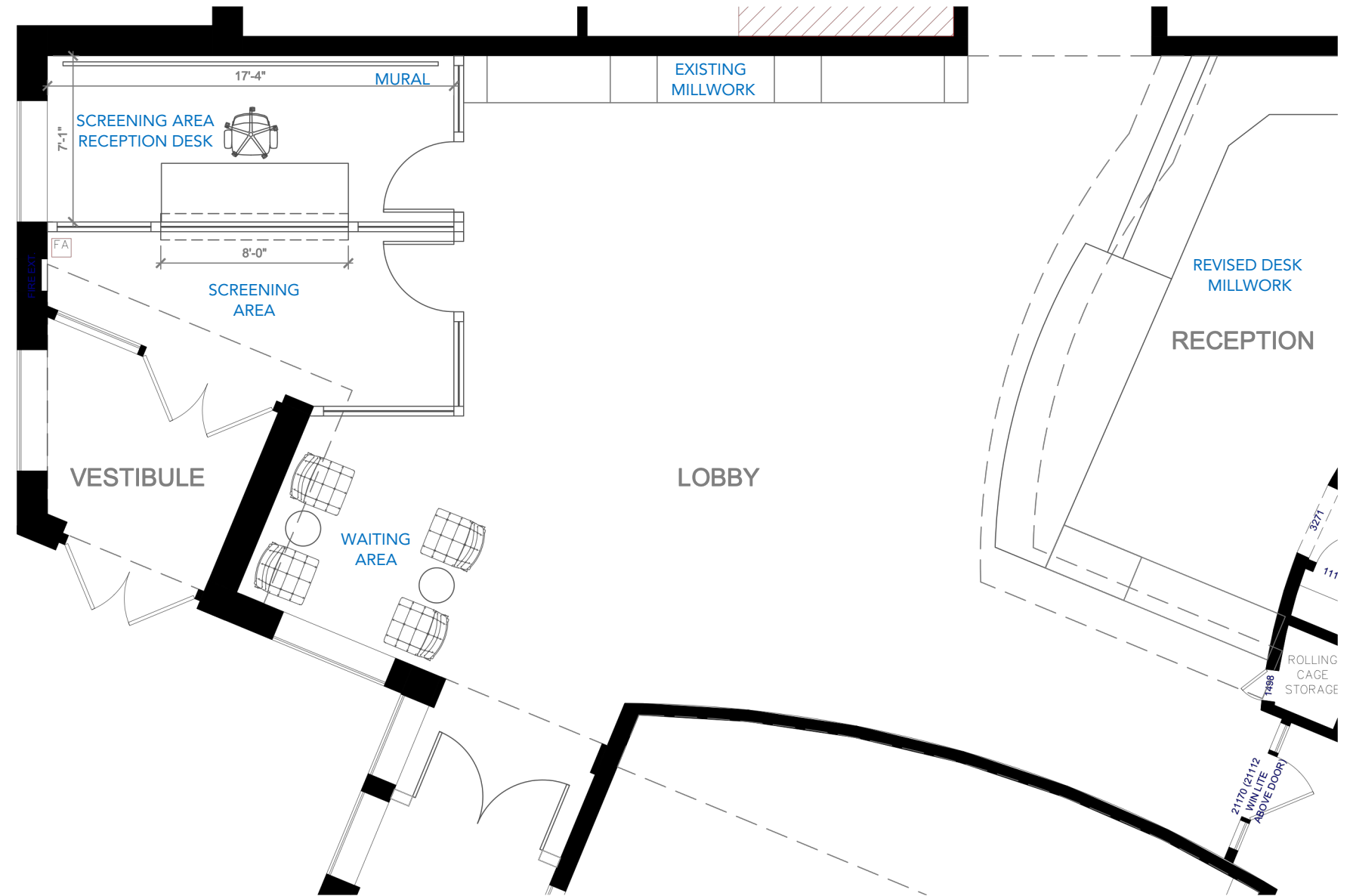

lobby plan OPTION 2

Features

- Creation of Screening Area separated from Lobby space with glass partitions/doors
- Doors to be unlocked electronically by receptionist for security purposes
- Seating located in waiting areas in Screening Area and Lobby
- Glass safety screen above desk to be integrated into new partitions, with opening at transaction area for guest interaction
- Privacy screen behind desk to conceal Screening Area receptionist (with a combination of clear and obscured glass)
- Mural to be suspended above desk height or remain on floor
- New double doors added at corridor entry leading to Council Chambers

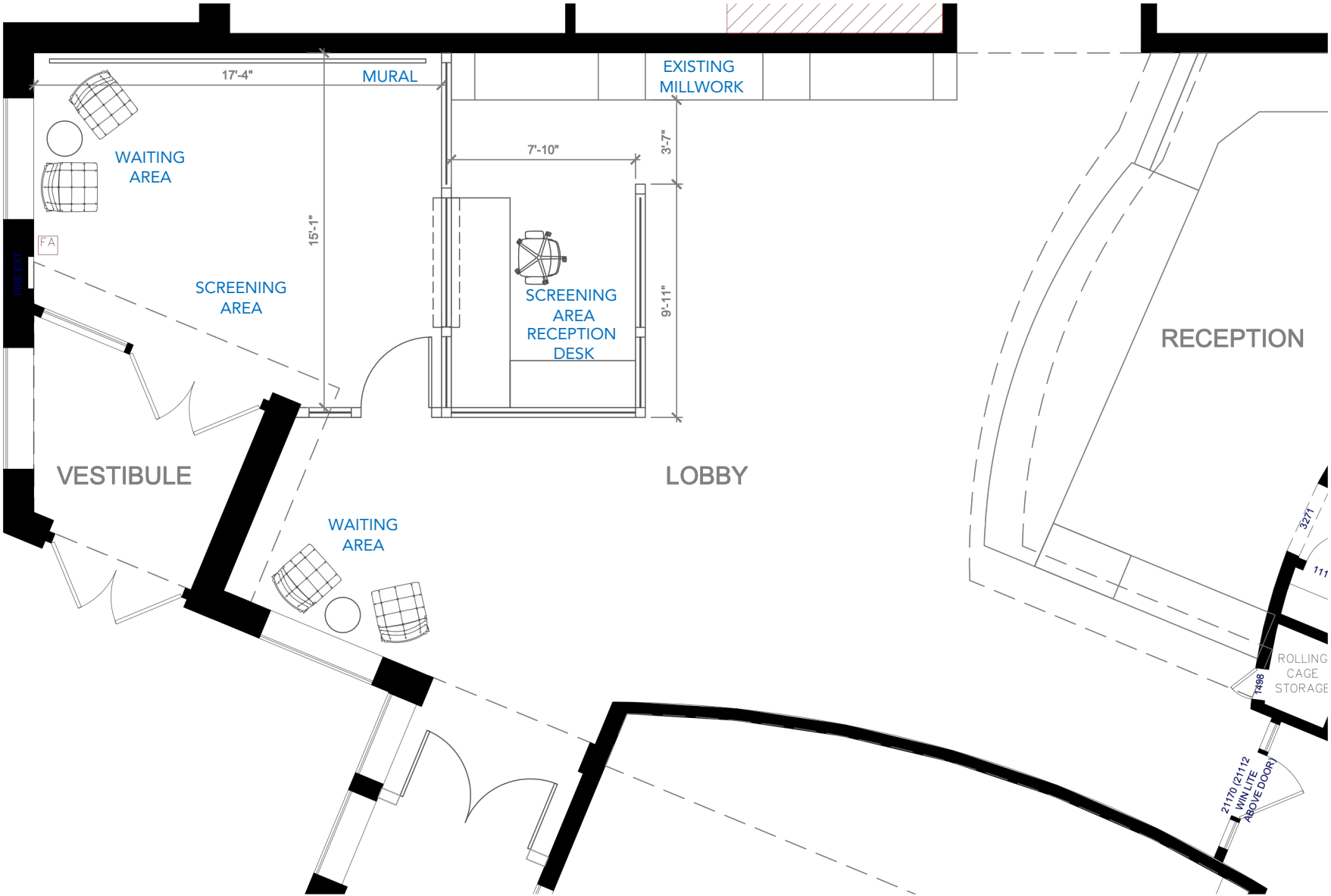

lobby plan OPTION 3

Features

- Creation of Screening Area separated from Lobby space with glass partitions/doors
- Doors to be unlocked electronically by receptionist for security purposes
- No seating available in Screening Area (located in Lobby only)
- Desk pulled away from window
- Glass safety screen to be secured to desk top with opening for guest interaction
- Mural to be suspended above desk height
- New double doors added at corridor entry leading to Council Chambers

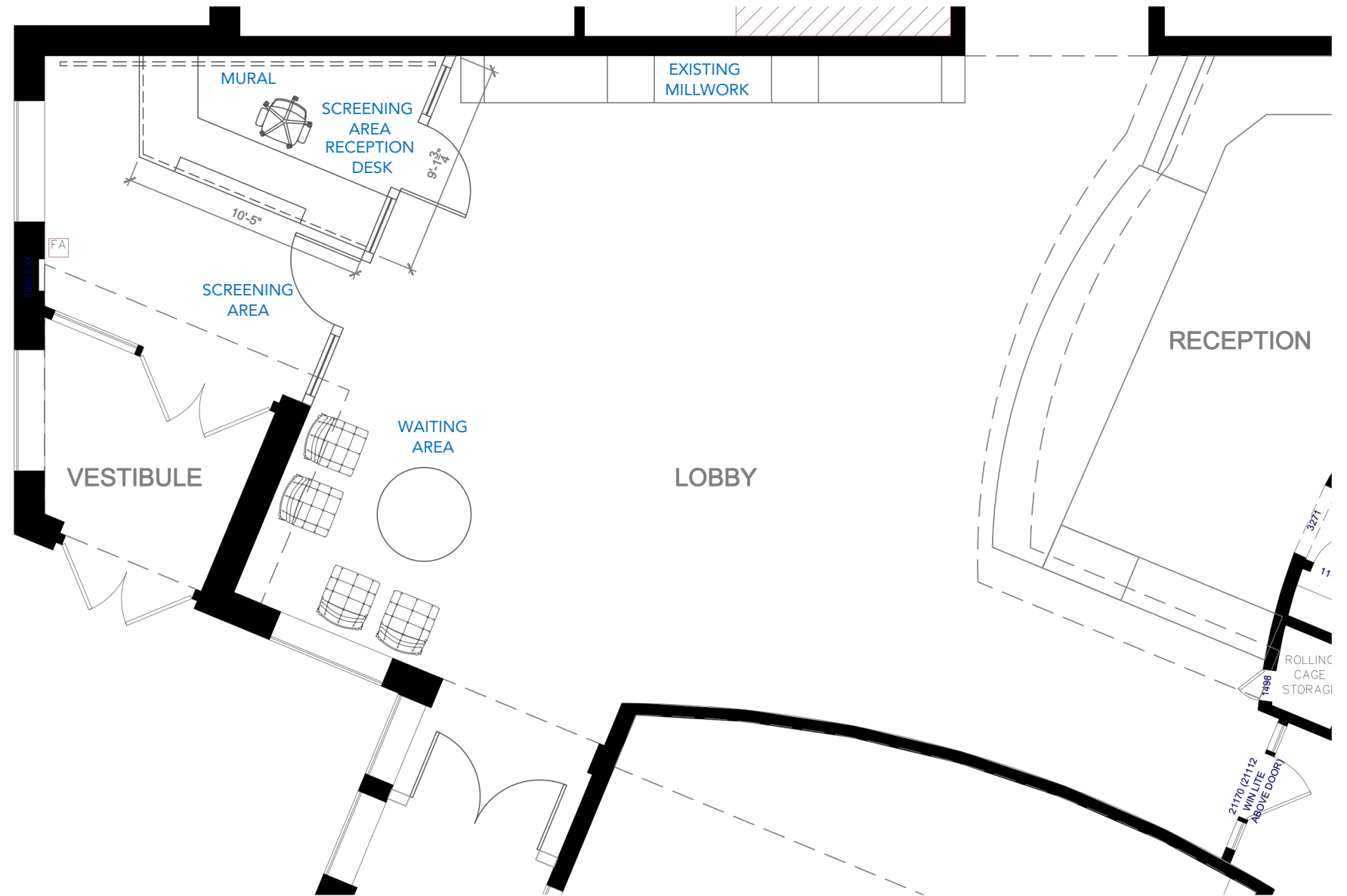

lobby plan OPTION 4

Features

- Creation of Screening Area separated from Lobby space with glass partitions/doors
- Doors to be unlocked electronically by receptionist for security purposes
- Secondary seating area created in Lobby area
- Glass safety screen above desk to be integrated into new partitions, with opening at transaction area for guest interaction
- Mural to be suspended above desk height or remain on floor
- New double doors added at corridor entry leading to Council Chambers

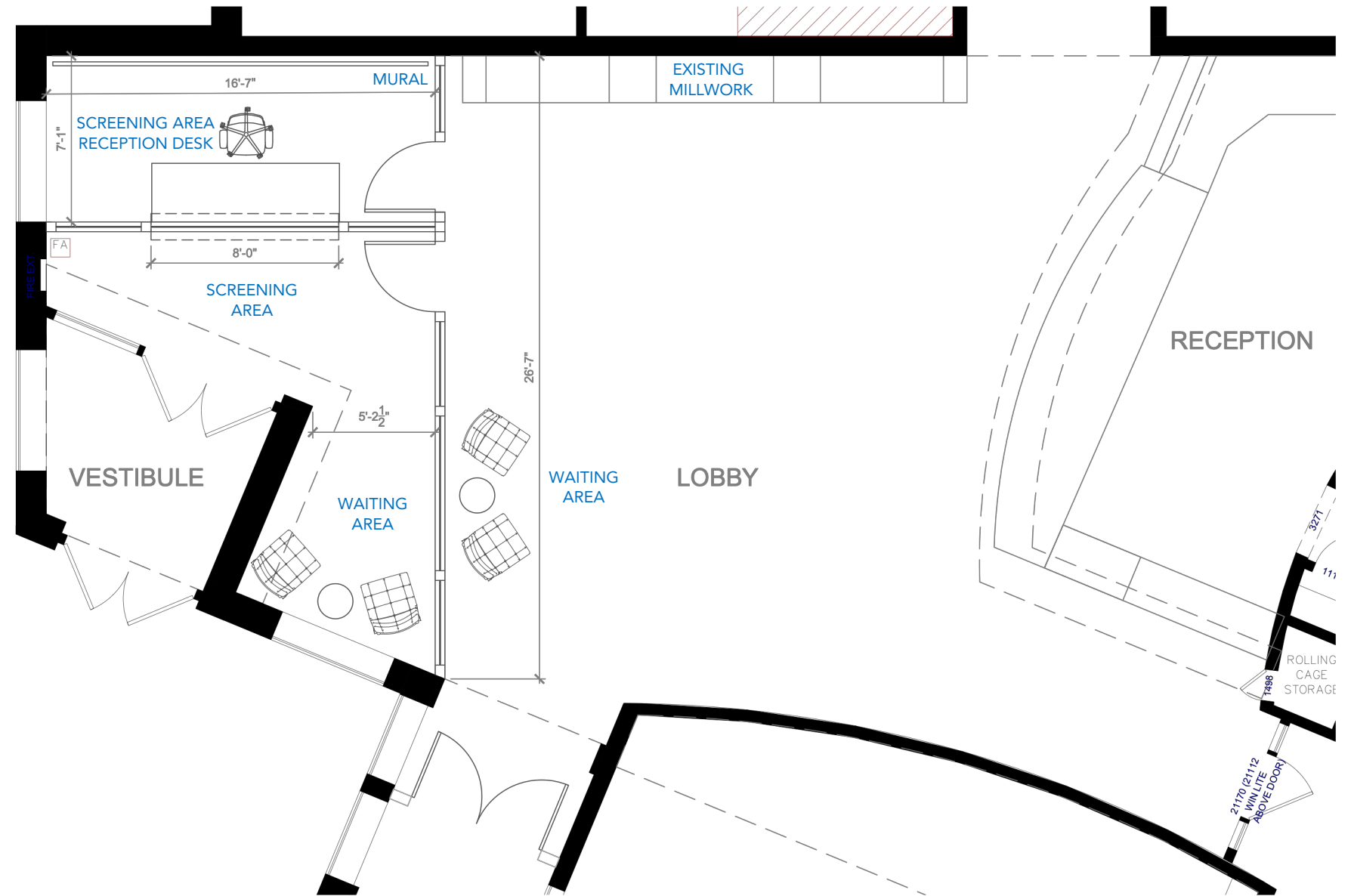

lobby plan OPTION 5

Features

- Creation of Screening Area separated from Lobby space with glass partitions/doors
- Doors to be unlocked electronically by receptionist for security purposes
- Large screening area with 2 separate waiting areas within
- Glass safety screen to be secured to desk top with opening for guest interaction
- Existing display millwork to be removed (wall behind to be restored as required)
- Mural to be suspended above desk height
- New double doors added at corridor entry leading to Council Chambers

