

| Existing Land Use Bylaw 819/96   |  | Proposed Land Use Bylaw 1385/17         |   |  |
|----------------------------------|--|---|---|--|
| District:                        | Existing Regulation:   | District:                               | Proposed in Public Hearing Draft:   | Proposed in Final Draft:   |
| AG: Agricultural                 | <ul style="list-style-type: none"> <li>Temporary Dwelling (Permitted)</li> <li>Second Temporary Dwelling (Discretionary on 80+ acres)</li> </ul> | AG: Agricultural - Major (16+ Ha)       | <ul style="list-style-type: none"> <li>Secondary Dwelling (Discretionary on 80+ acres)</li> </ul> | <ul style="list-style-type: none"> <li>Second Dwelling <i>or</i> Secondary Suite (Discretionary on 80+ acres)</li> <li>Farm Help Accomodation (Permitted)</li> </ul> |
|                                  |  | AG: Agricultural - Minor (4 to 15.9 Ha) |   | <ul style="list-style-type: none"> <li>Secondary Suite (Discretionary)</li> <li>Farm Help Accomodation (Permitted)</li> </ul>  |
|                                  |  | AG: Agricultural - Residential (<4 Ha)  |   | <ul style="list-style-type: none"> <li>Farm Help Accomodation (Permitted)</li> </ul>   |
| CR-1: Country Residential One    | <ul style="list-style-type: none"> <li>Temporary Dwelling (Discretionary in 6 communities only)</li> </ul>                                       | R1: Country Residential                 |   | <ul style="list-style-type: none"> <li>Secondary Suite (Discretionary)</li> </ul>  |
| CR-E: Country Residential Estate |  | R2: Country Estate Residential          |   | <ul style="list-style-type: none"> <li>Secondary Suite (Discretionary)</li> </ul>  |
| HR: Hamlet Residential           |  | R3: Hamlet Unserviced                   |   | <ul style="list-style-type: none"> <li>Secondary Suite (Discretionary)</li> </ul>  |
|                                  |  | R4: Hamlet Serviced                     |   | <ul style="list-style-type: none"> <li>Secondary Suite (Discretionary)</li> </ul>  |

Note: "Temporary Dwellings" entail a mobile home for either family care or farm help purposes *only*.

Note: a "Secondary Dwelling" entails a permanent house for any purpose/occupant. "Farm Help Accomodation" enables farm worker housing.

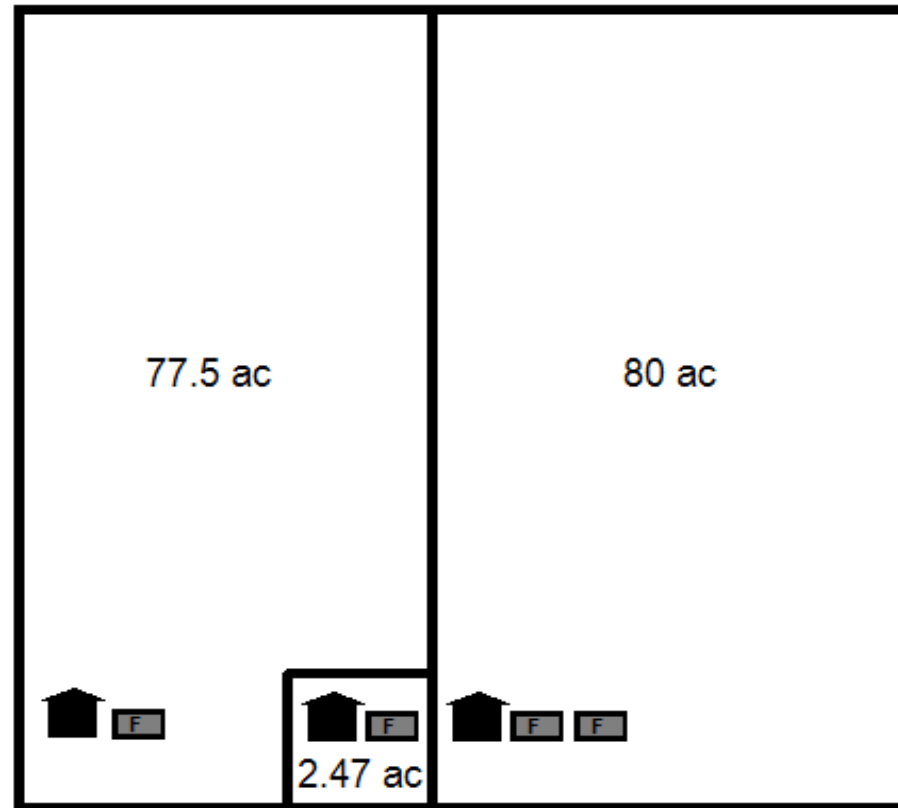

Existing Land Use Bylaw 819/96  
7 dwellings units

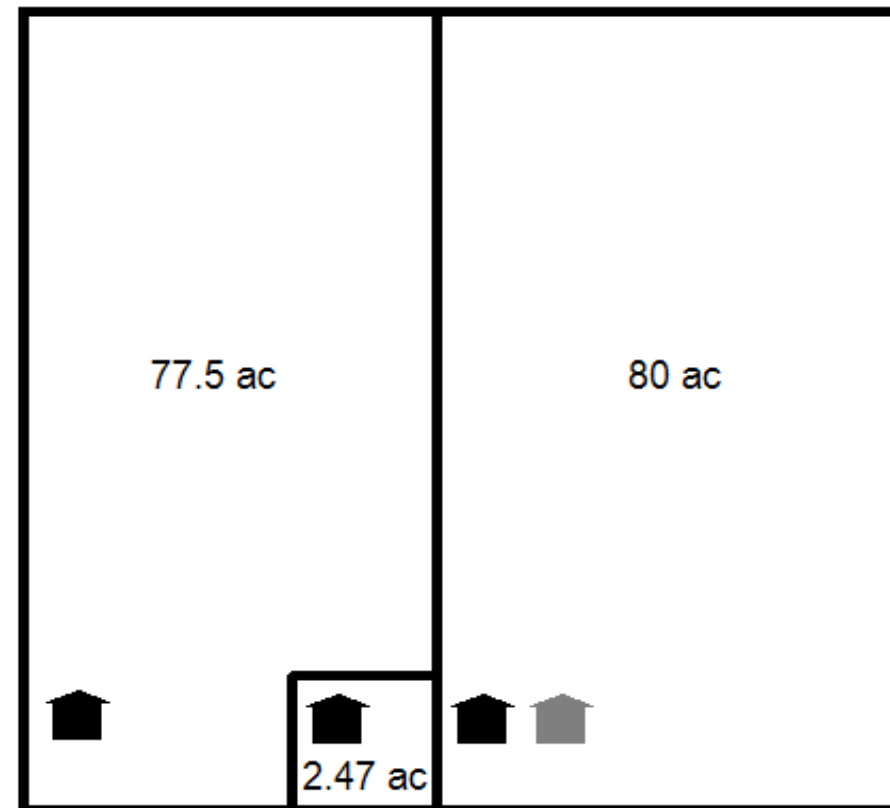

Proposed Land Use Bylaw 1385/17 (Public Hearing Draft)  
5 dwelling units

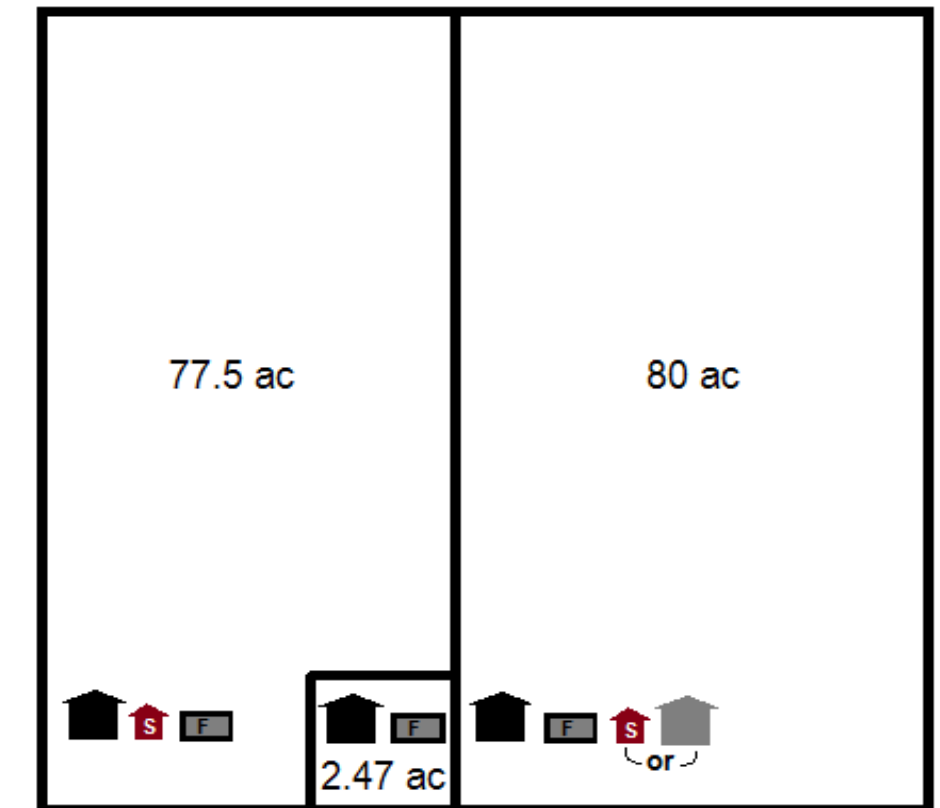

Proposed Land Use Bylaw 1385/17 (Final Draft Version)  
7 dwellings units