

# Proposed Sites for Additional Dust Suppression Subsidy

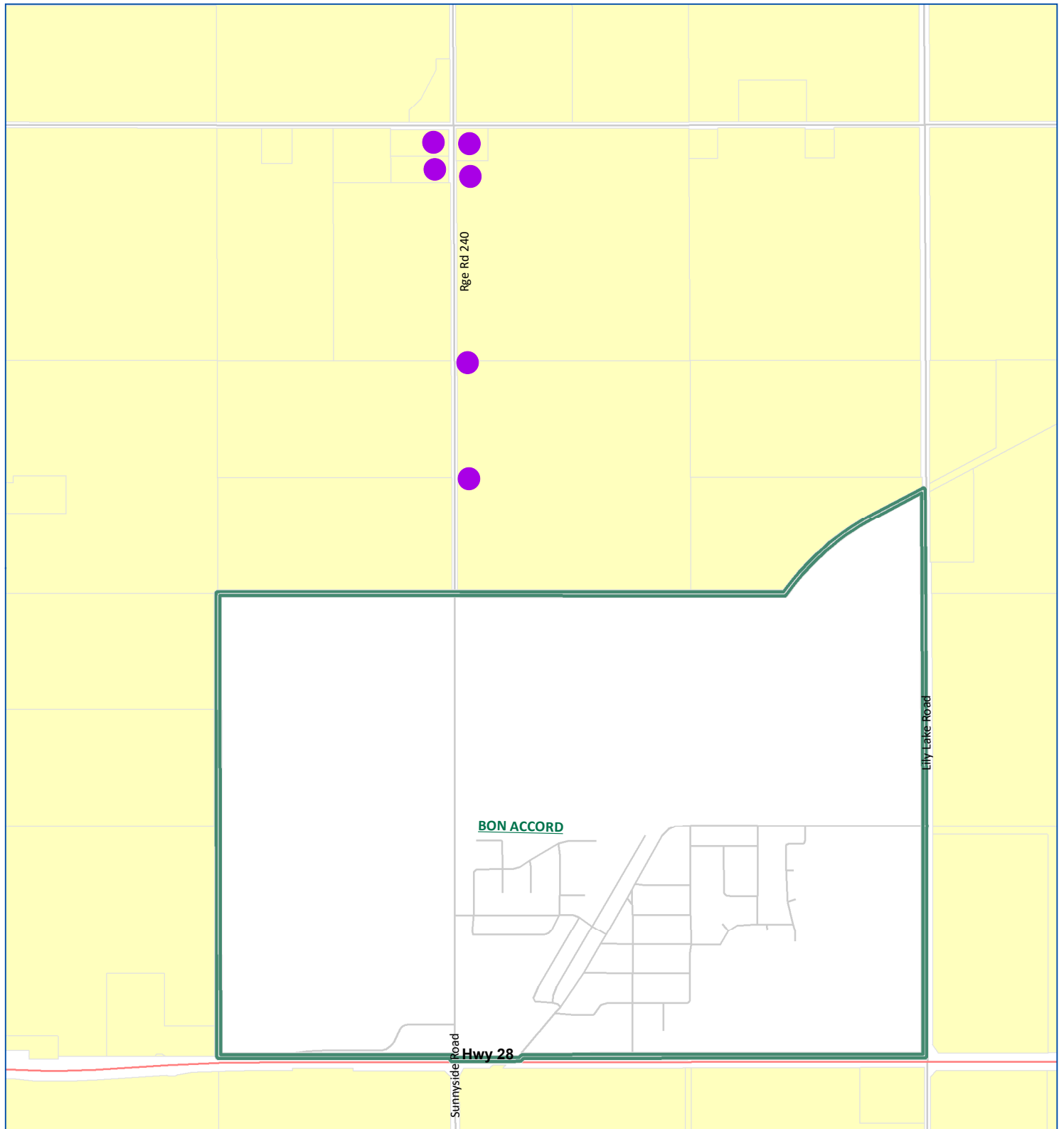

## Range Road 240 North of Bon Accord



● Potential Affected Residences

Disclaimer: The information on these maps is based on the most current information available to SCGIS. The information on this map is not intended to replace engineering, financial or primary records research. NAD 1983 10TM AEP Resource

1:18,621



**Sturgeon County**  
Geographic Information System

# Proposed Sites for Additional Dust Suppression Subsidy

## Range Road 252 North of Hwy 651

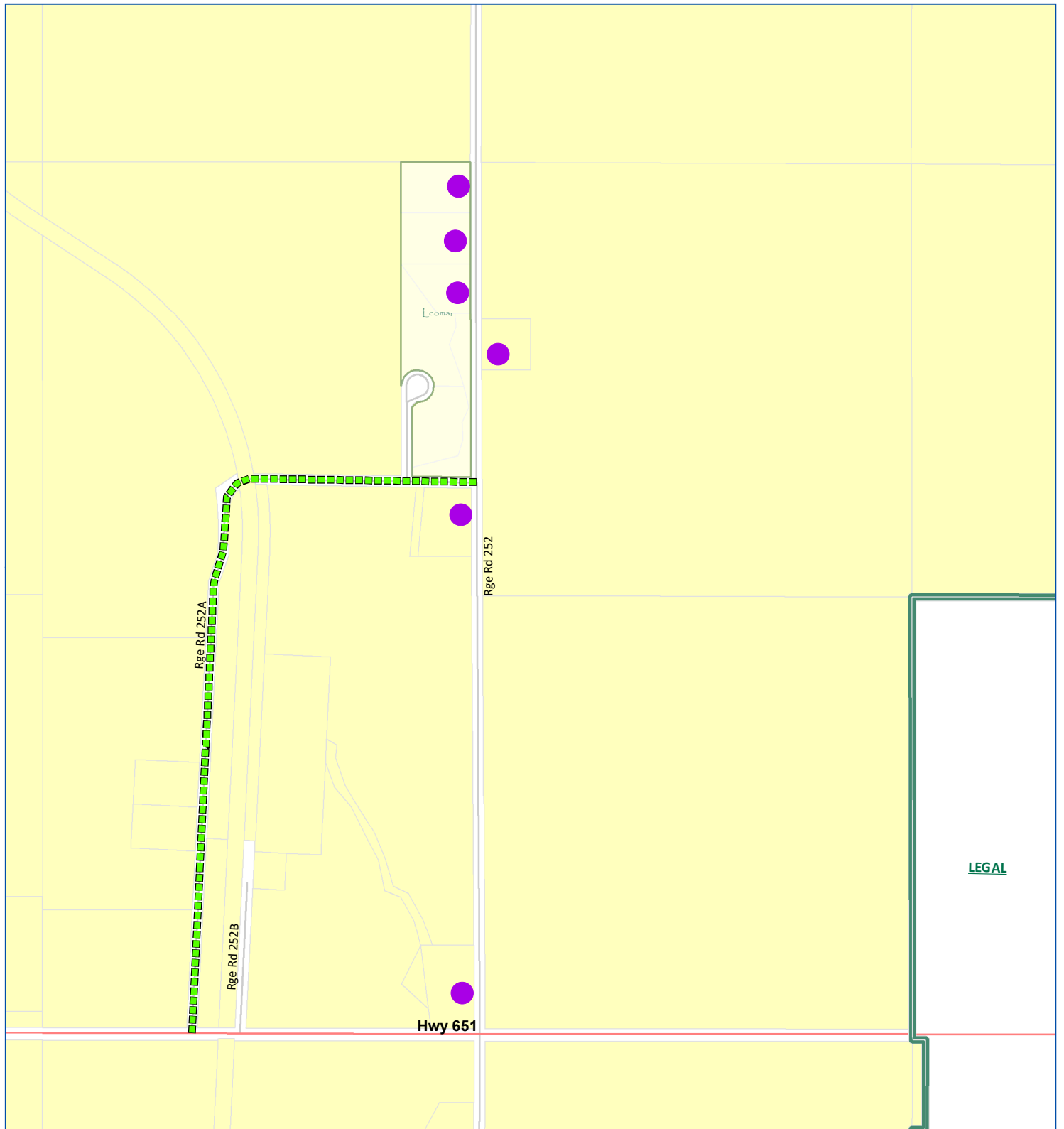

● Potential Affected Residences

■ Haul Routes

Disclaimer: The information on these maps is based on the most current information available to SCGIS. The information on this map is not intended to replace engineering, financial or primary records research.  
NAD 1983 10TM AEP Resource

1:10,000



**Sturgeon County**  
Geographic Information System