

Complimentary Dust Suppression

Designated Haul Routes 2020



Rge Rd 261: Hwy 633 to Hwy 37
Rge Rd 260: Twp Rd 544 to Hwy 37

Designated Haul Routes
(Landfill / Water Station)

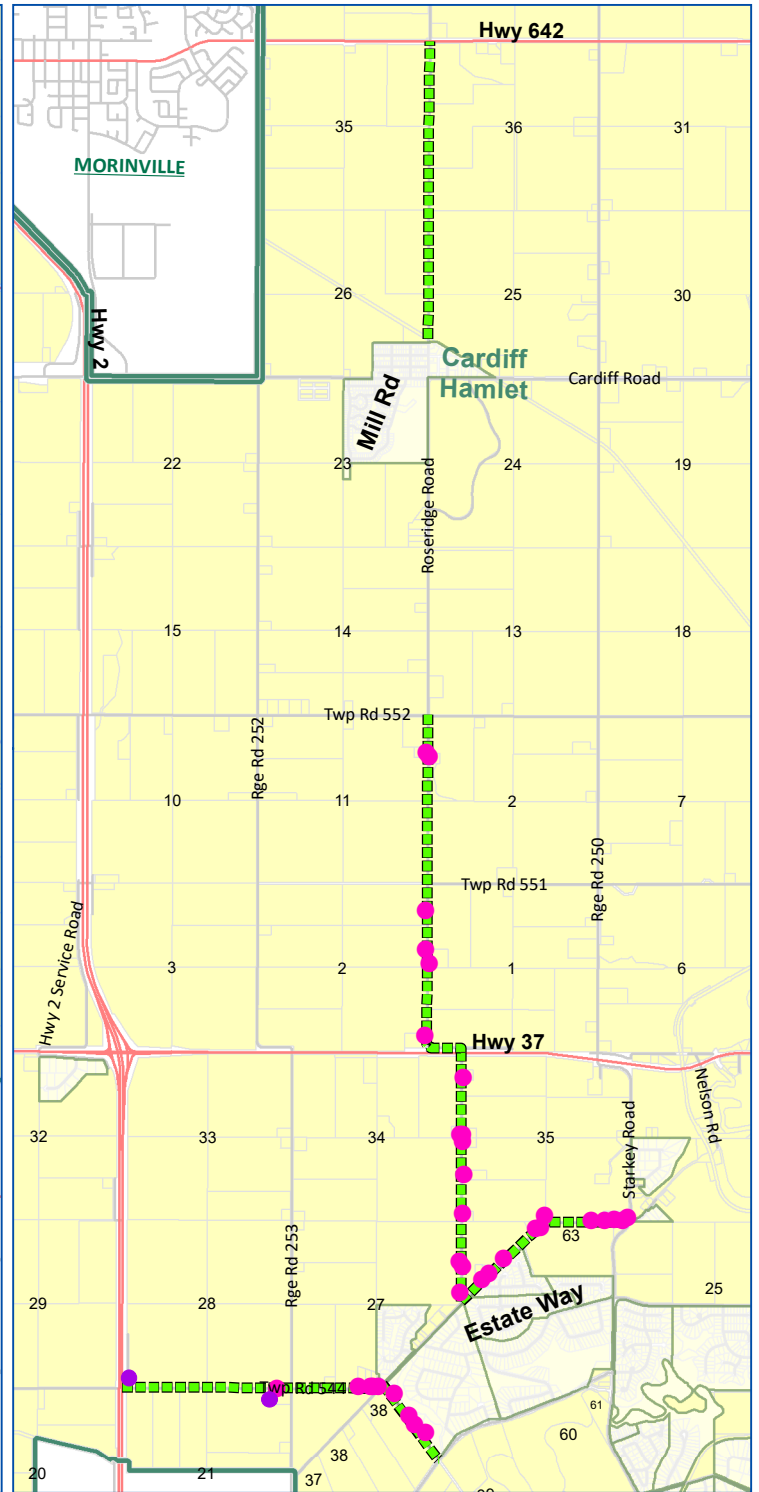
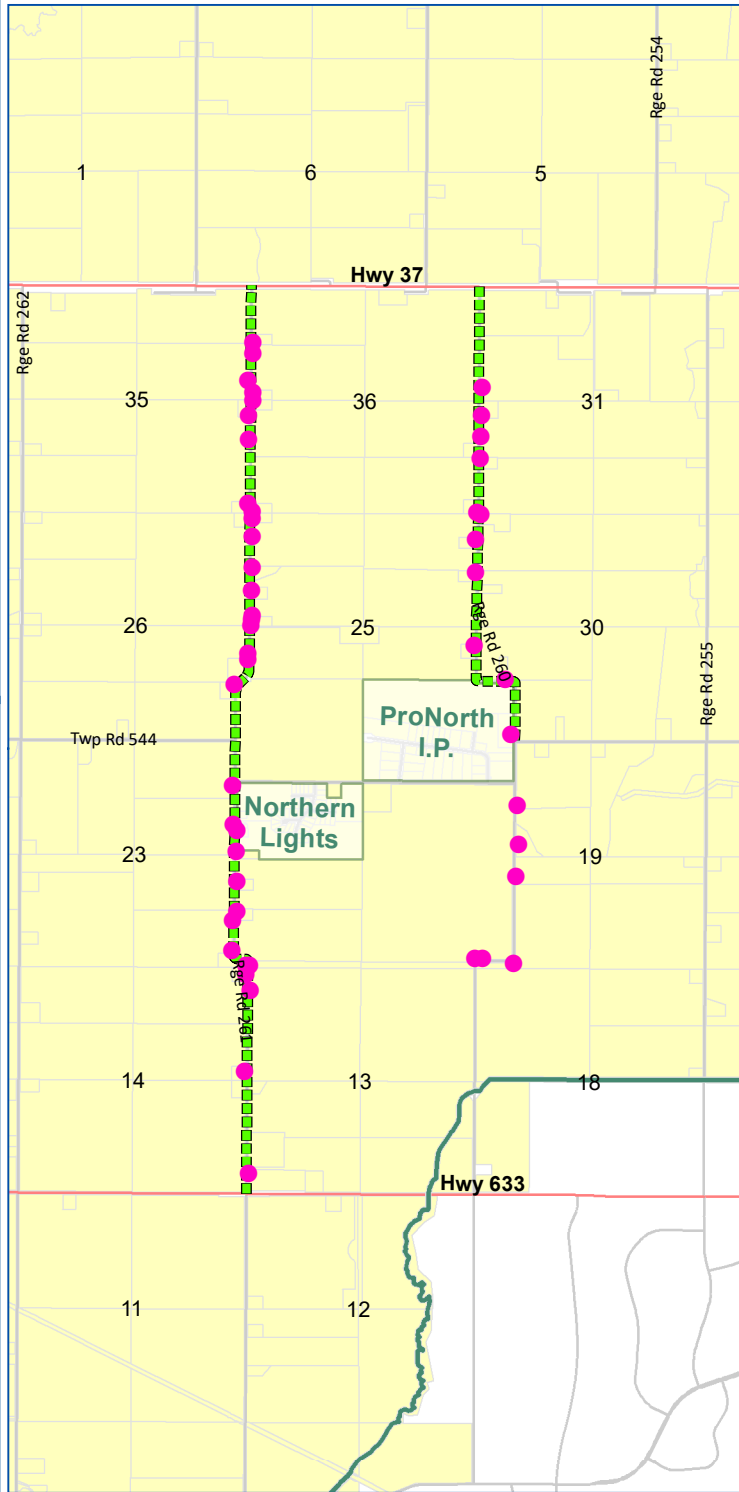

- Proposed Site
- Affected Residences
- - - - - Haul Routes

Disclaimer: The information on these maps is based on the most current information available to SCGIS. The information on this map is not intended to replace engineering, financial or primary records research. NAD 1983 10TM AEP Resource



Sturgeon County
 Geographic Information System

Complimentary Dust Suppression - East

Designated Haul Routes 2020

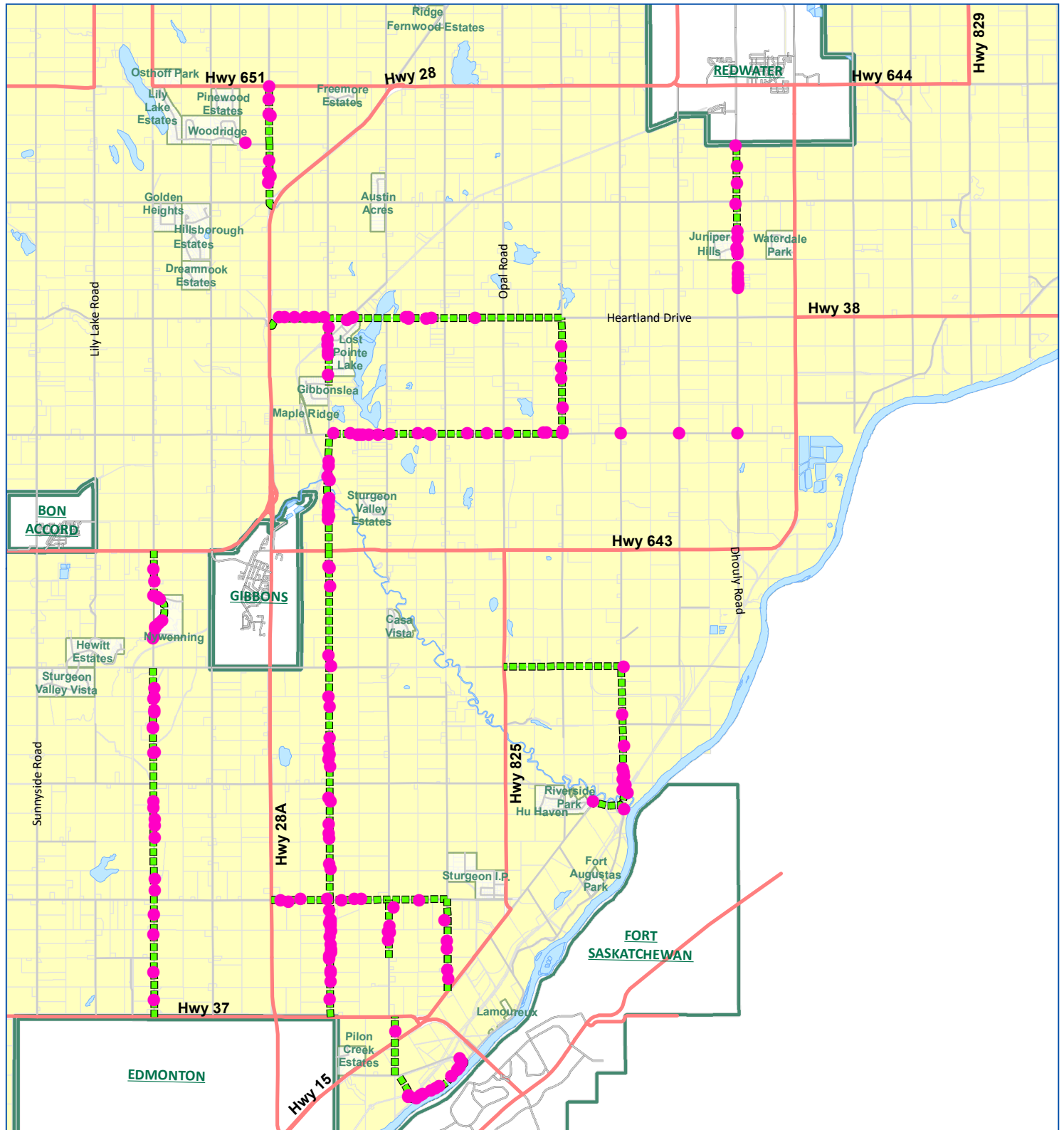

● Affected Residences

■■■■■ Haul Routes

Disclaimer: The information on these maps is based on the most current information available to SCGIS. The information on this map is not intended to replace engineering, financial or primary records research. NAD 1983 10TM AEP Resource

1:150,000



Sturgeon County
Geographic Information System

Complimentary Dust Suppression - West

Designated Haul Routes 2020

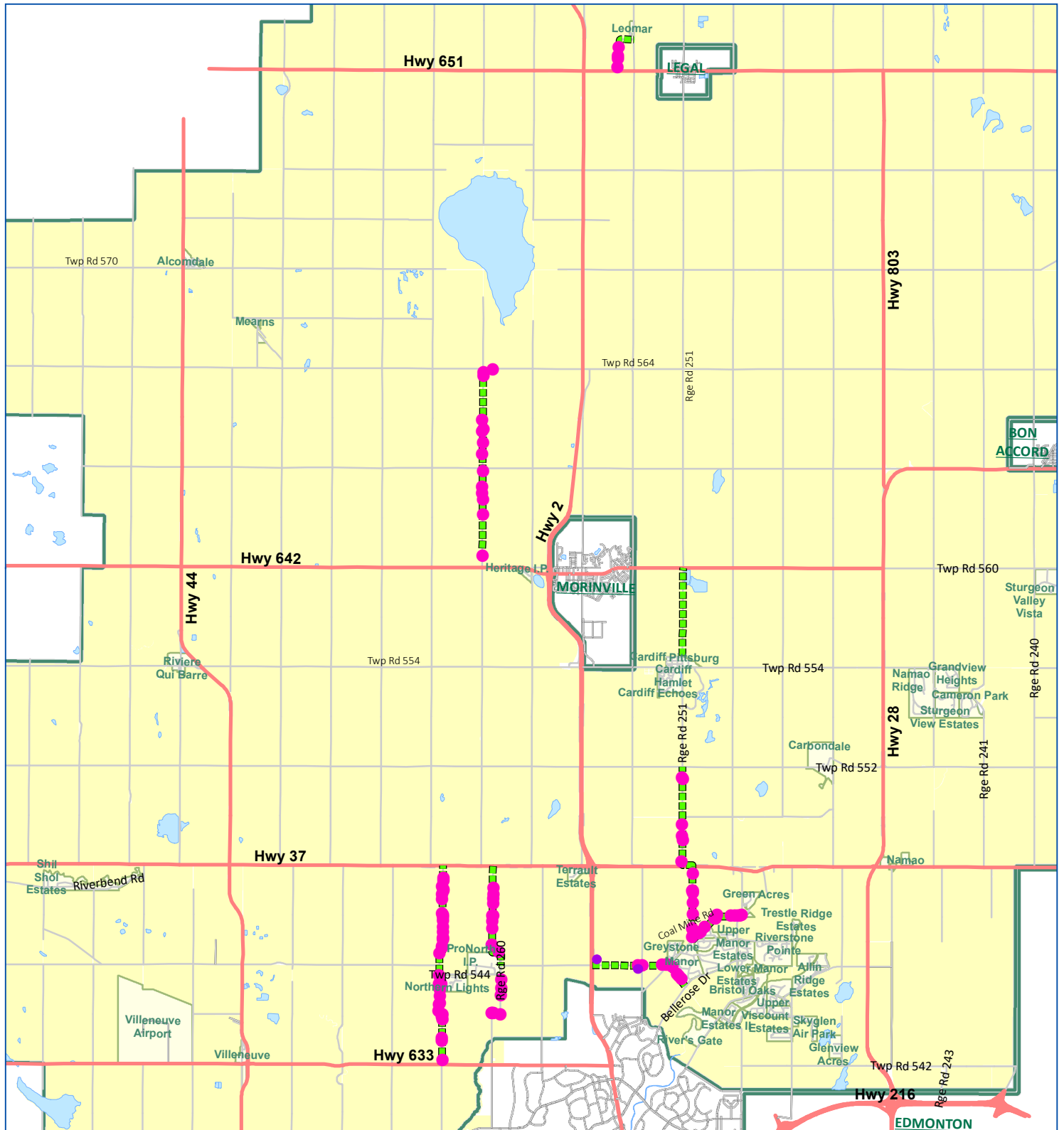

- Proposed Site
- Affected Residences
- - - - - Haul Routes

Disclaimer: The information on these maps is based on the most current information available to SCGIS. The information on this map is not intended to replace engineering, financial or primary records research.
NAD 1983 10TM AEP Resource

1:175,000



Sturgeon County
Geographic Information System

Complimentary Dust Suppression

Designated Haul Routes 2020

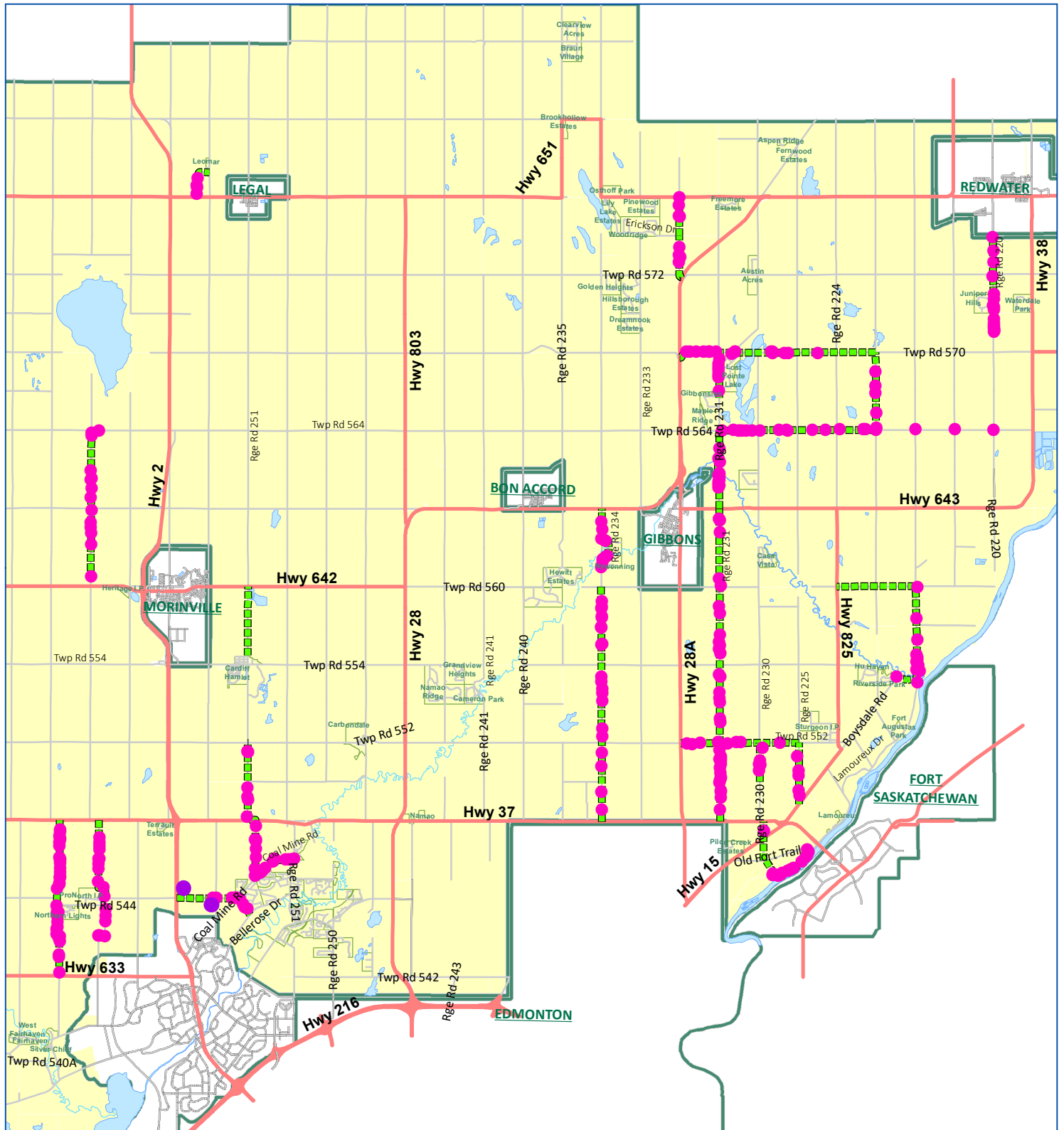

- Proposed Site
- Affected Residences
- - - - - Haul Routes

Disclaimer: The information on these maps is based on the most current information available to SCGIS. The information on this map is not intended to replace engineering, financial or primary records research.
NAD 1983 10TM AEP Resource

1:223,233

